

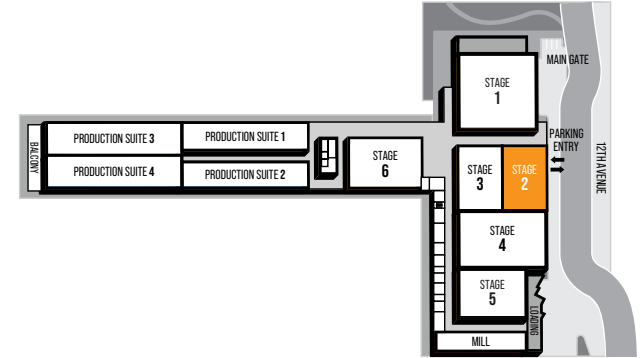

# SUNSET PIER 94 STUDIOS · STAGE 2

755 12<sup>th</sup> Ave, New York, NY 10019 · Sales@SunsetStudios.com · (323) 860-8100

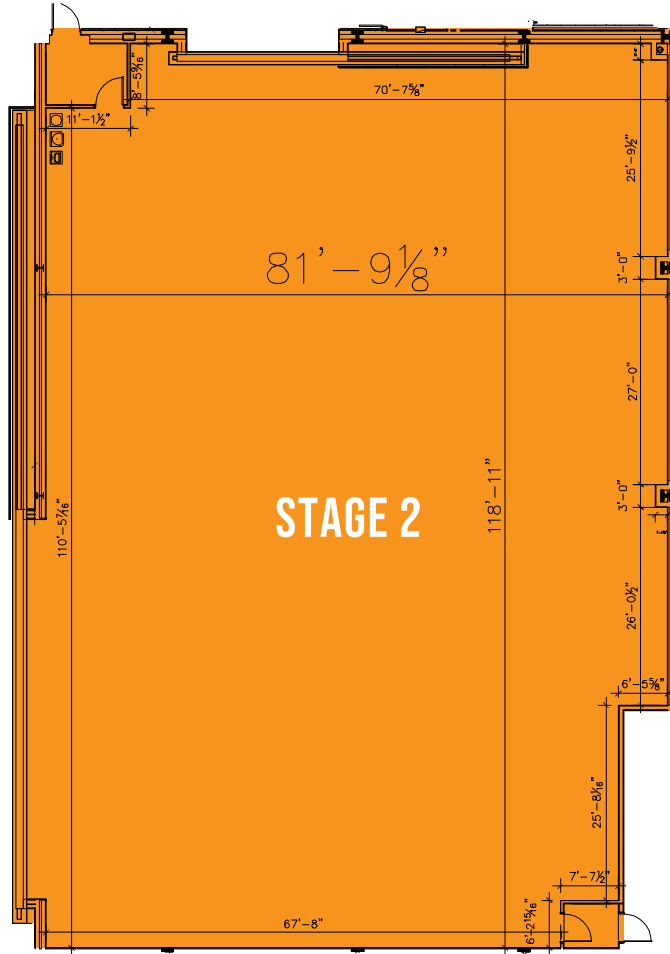

WIDTH	LENGTH	HEIGHT	TOTAL STAGE SQUARE FOOTAGE	FLOOR TYPE	DOOR (WxH)
81'	118'	36'	9,921 SF	PLYWOOD/CONCRETE	20' X 18'

\*Dimensions are for overall space size and do not take into account stage irregularities. Production company representative should verify dimensions for particular applications.



# SUNSET PIER 94 STUDIOS · STAGE 2

755 12<sup>th</sup> Ave, New York, NY 10019 · [Sales@SunsetStudios.com](mailto:Sales@SunsetStudios.com) · (323) 860-8100

## STAGE SPECIFICATIONS

Width - 81'

Length - 118'

Height - 36'

Total Square Footage - 9,921 SF

Elephant Door - 20W' x 18H', acoustically rated STC 55-60

Floor Type - Plywood/concrete acoustically isolated slab buildup

Floor Weight Capacity - 250 PSF live load

Ceiling Load Capacity - 25 PSF live load

Lighting Grid - Yes

Catwalks - No

## ELECTRIC SERVICE

1,600amps; 120/208V, 3 phase 4,800amps; 120V

Tech Power - Yes

Power in Grid - No

## HVAC

HVAC - Yes - Silent Air

Acoustic Rating - NC 25

Redlight Control - Yes

Ventilation - 60 Nominal Tons

Heating - Yes

## STAGE EXTRAS

Hose Bib - No

Gas - No

Compressed Air - No

Audience Rated (Occupancies) - 94

Internet - Fiber and copper Cat-6a

Control Room - Connectivity Available

Control Room Note - 1 Main Production Control Room, 1 audio control room, 1 camera shading room — subject to availability. Data conduits and fiber connects control room to all stages.