

## Stage 9

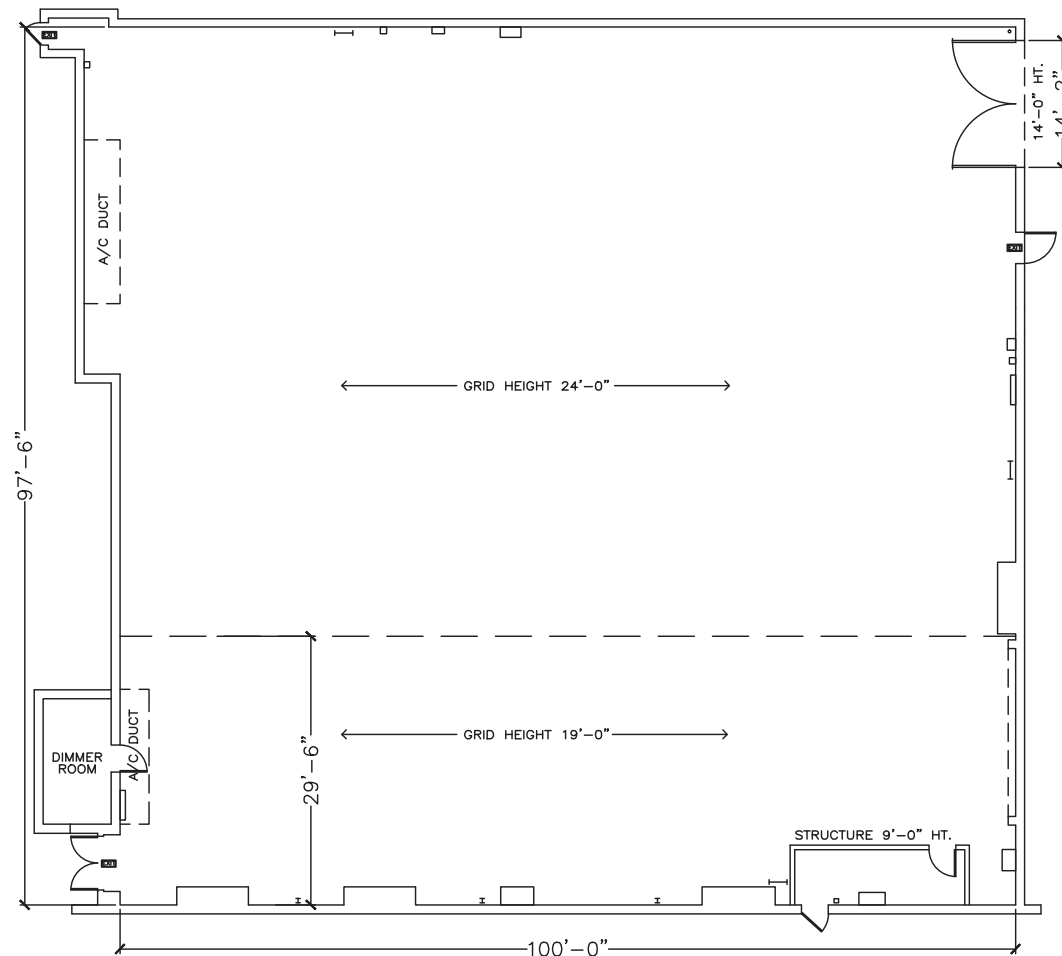

Width	Length	Height (Perms)	Total Stage Square Footage	Floor Type	Door (WxH)
99'	100'	24'6" & 19'	10,750	Wood	14'2" X 14'

# Stage Specifications: Stage 9

---



## Stage Specifications

Width – 99'  
Length – 100'  
Height (Perms) – Main: 24'6" Low: 19' See Diagram  
Total Square Footage – 10,750 SF  
Floor – Wood over slab  
Elephant Door (W X H) – 14'2" X 14'

## Additional Info

Audience Rated – 250 + crew  
Drive-In – Yes  
Cat Walks – Yes

## Support Space

Control Room Connectivity – Yes; SMPTE fiber & audio break-outs/tech power  
Dressing Rooms, Wardrobe, and Hair + Make Up rooms are available in adjacent buildings

## Heavy Equipment

Stage Management to authorize

## Electric Service

Production Power – 2 - switchable buss bars; 120/208 volt @ 3 phase 800 amps per phase 4800 amp total  
240 Volts – No  
480 Volts – No  
Tech Power – Available

## HVAC

80 tons  
Redlight Control – Yes  
Ventilation – Yes  
Heating – No

## Stage Extras

Hose Bib – Yes  
Gas – Yes  
Drain – No  
Compressed Air – Yes  
Wireless Internet – Available  
Phone – Available  
Fax – Available