

## Stage 6

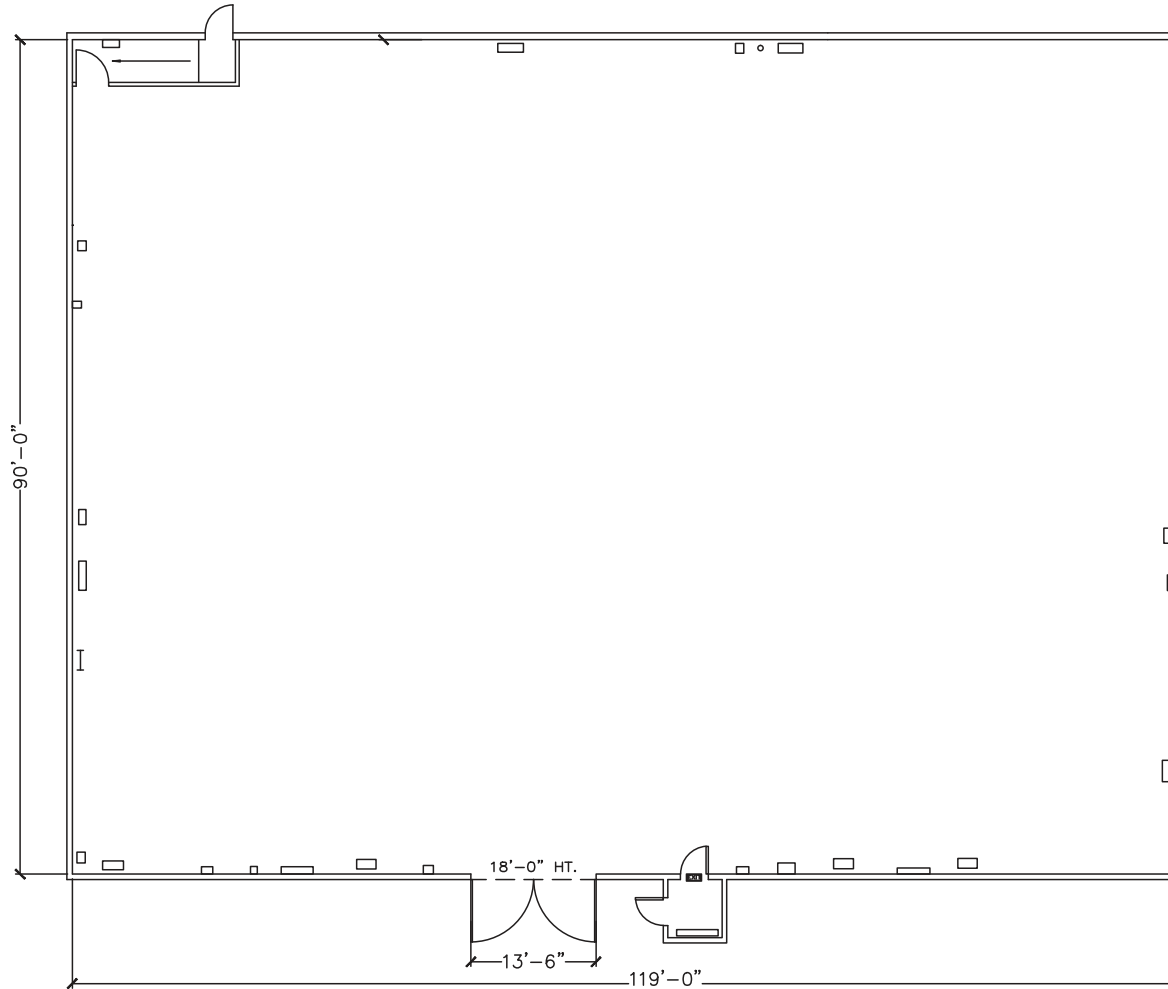

Width	Length	Height (Perms)	Total Stage Square Footage	Floor Type	Door (WxH)
90'	119'	24'	11,276	Wood	13'6" X 18'

# Stage Specifications: Stage 6

---



## Stage Specifications

Width – 90'  
Length – 119'  
Height (Perms) – 24'  
Total Square Footage – 11,276 SF  
Floor – Wood over slab, small pit  
Elephant Door (W X H) – 13'6" X 18'

## Additional Info

Audience Rated – No  
Drive-In – Yes  
Cat Walks – Yes

## Heavy Equipment

Stage Management to authorize

## Electric Service

Production Power – 1 Switchable buss bar 120/208 Volt @3 phase 1000 amps per phase 3000 amps total  
240 Volts – No  
480 Volts – No  
Tech Power – Available

## HVAC

80 tons  
Redlight Control – Yes  
Ventilation – Yes  
Heating – No

## Stage Extras

Hose Bib – Yes  
Gas – Yes  
Drain – No  
Compressed Air – Yes  
Wireless Internet – Available  
Phone – Available  
Fax – Available