

Stage 8

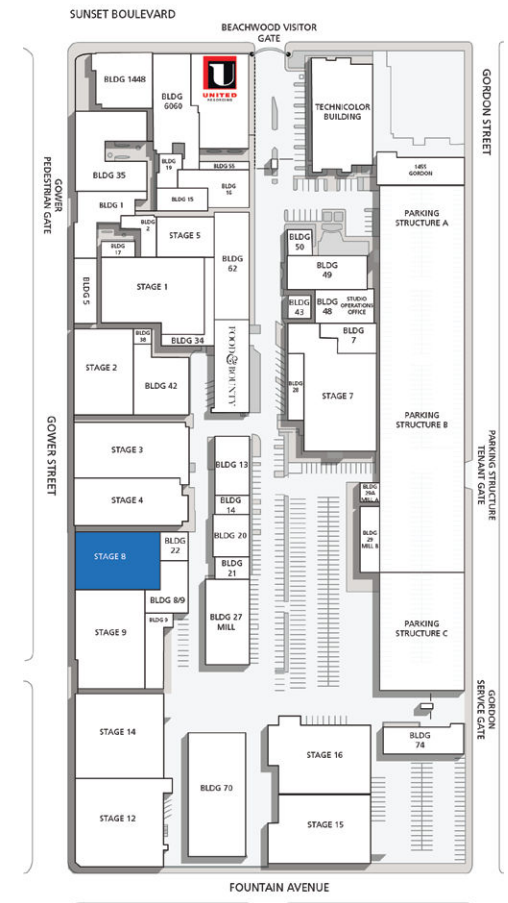

| Width | Length | Height (Perms) | Total Stage Square Footage | Floor Type | Door (WxH) |
|-------|--------|----------------|----------------------------|------------|-------------|
| 83' | 126'5" | 35'4" | 10,916 | Wood | 15'2" x 20' |

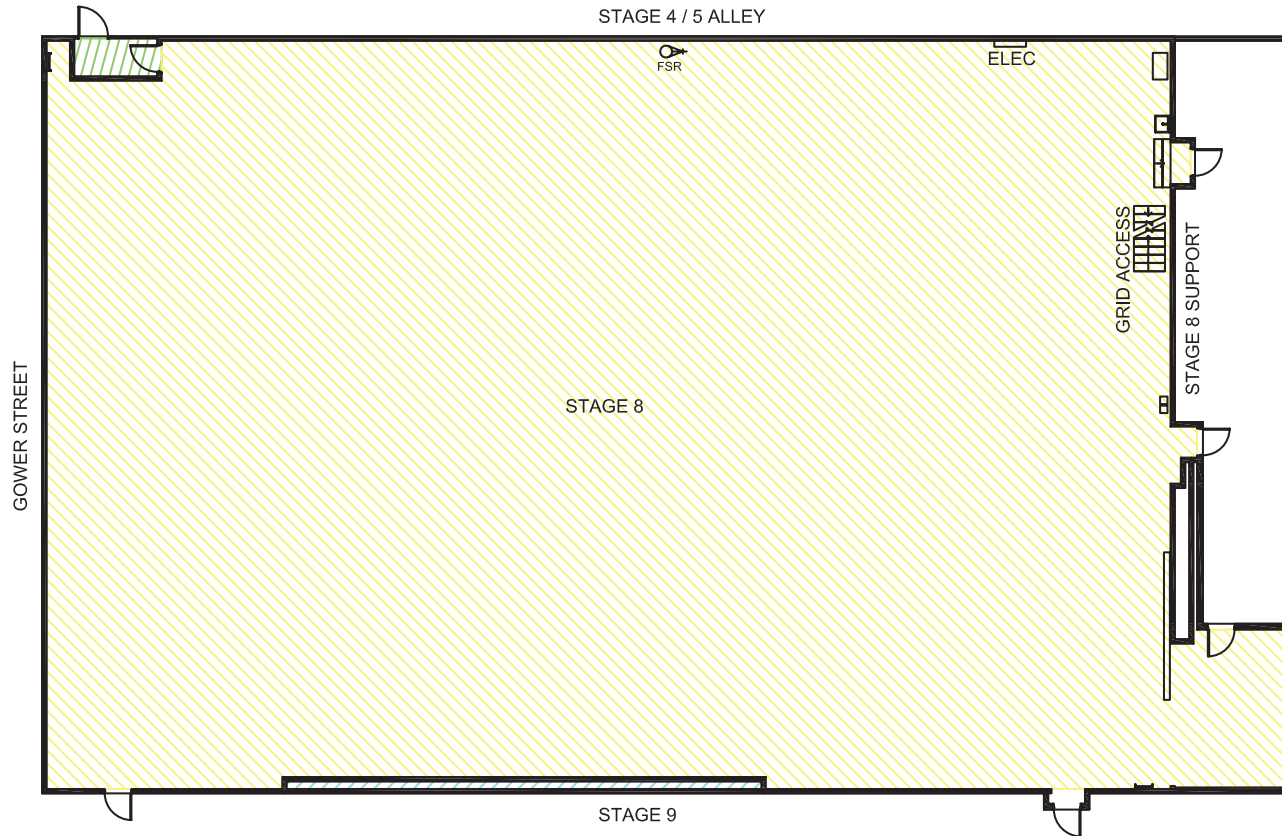
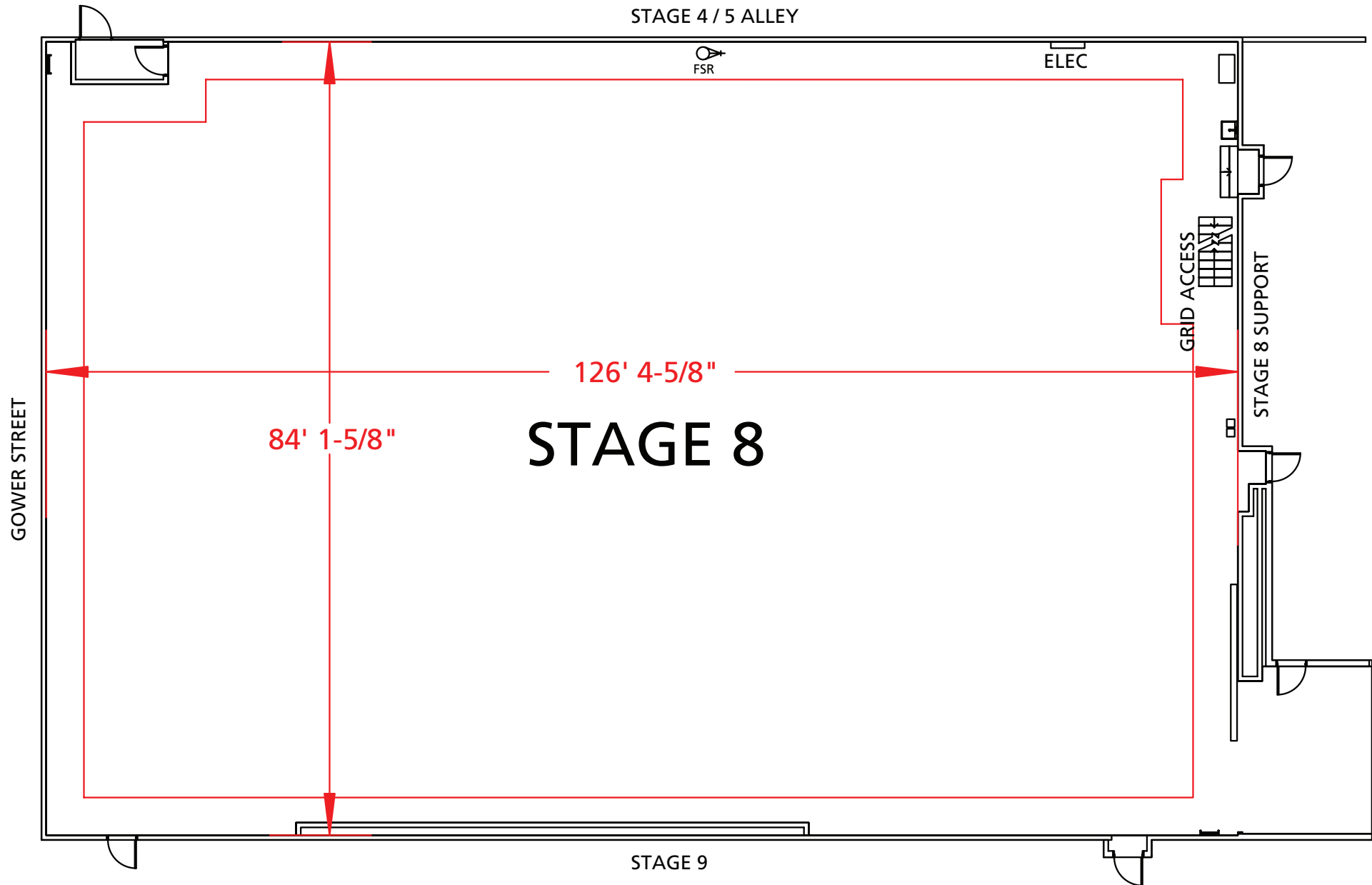

Stage Specifications: Stage 8



Stage Specifications - (Dimensions Include 4' Fire Lane)

Width – 83'
Length – 126' 5"
Height (Perms) – 35' 4"
Total Square Footage – 10,916
Floor Type – Wood
Elephant Door (W X H) – 15' 2" X 20'

Support Space- (Available On Stage)

Support 8: 1 Green Room 2 Support Rooms
Support 8/9: 4 Support Rooms 1 Kitchen (Shared With Stage 9)

Heavy Equipment

Stage Management to authorize

Electric Service

Production Power - 120/208 800 Amp Per Phase Bus Bar, 4800 Amp Total Standard. Additional 2400 Amps Available
240 Volts - No
480 Volts - No
Tech Power - Available
Power In Grid – Available

HVAC

33 Ton (Nominal) Cooling Only Package Unit
33 Ton Cooling / Heat Package Unit
Redlight Control - Yes
Ventilation - Yes
Heating – Yes

Stage Extras

Hose Bib - No
Gas - No
Drain - Yes
Compressed Air - No
Wireless Internet – Available
Phone – Available
Fax – Available