

Stage 6

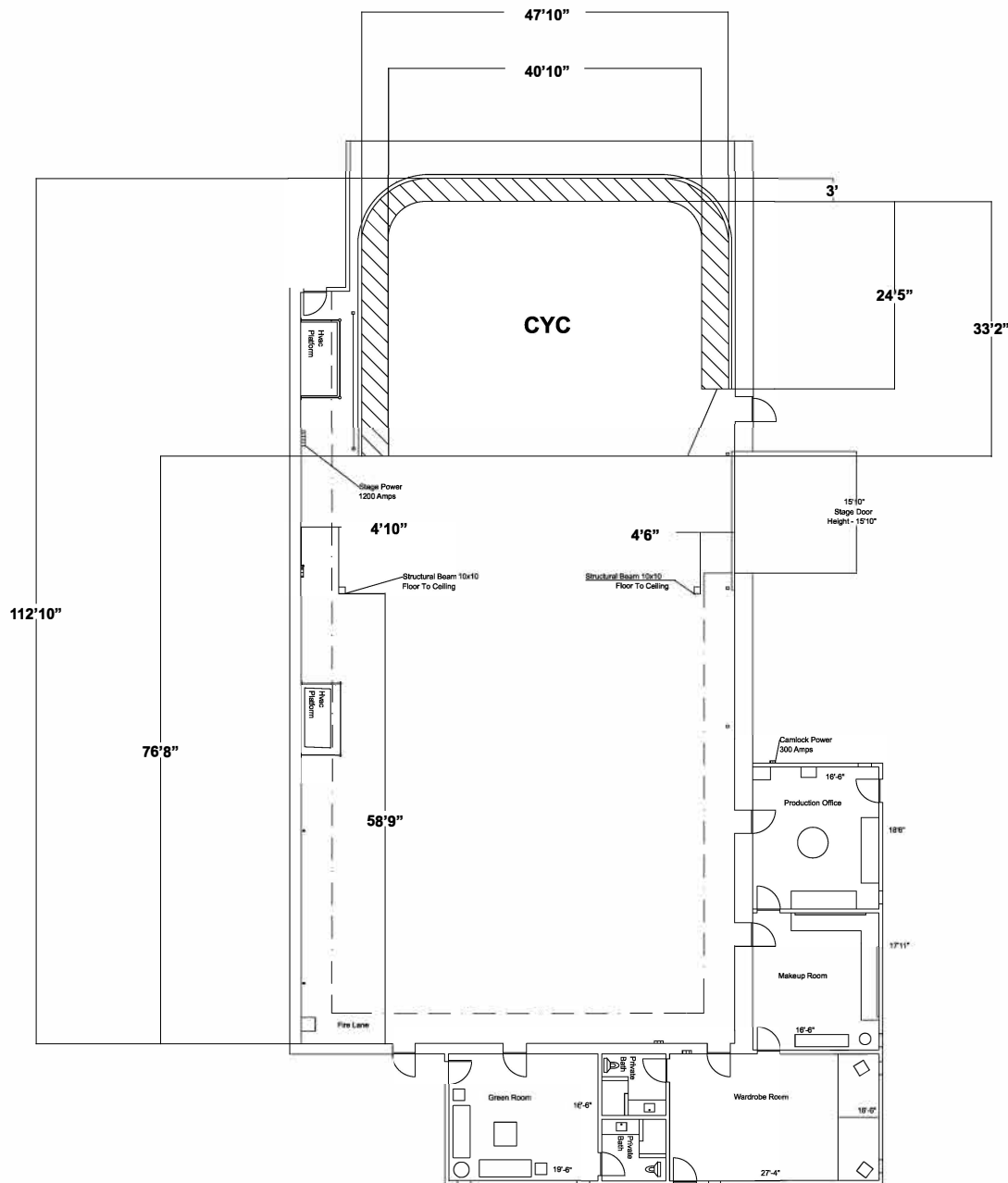

Specs

- 7,134 SF
- 47' x 112' x 21'
- 48' x 36' x 21' –
- 3 Wall Cyc
- 21' to Grid
- 1200 amps – 3 Phase
- 40 tons HVAC
- Elephant Door – 16' x 16'

Features

- Access To Coffee Bar & Common Area
- 6' Mirror
- All-In-One Printer/Fax/Copier
- Client Lounge
- Dedicated Parking
- Make-Up Room w/ 5 Stations
- Green Room w/ Private Bathroom & Shower
- Wardrobe Room w/ Private Bathroom & Shower
- Full Refrigerator
- Multi-Line Telephone
- Production Office
- Sound Proof
- Wardrobe Racks
- WiFi Available

