

# SKY BOX

**FEATURES**  
DELUXE WARDROBE  
+ MAKEUP ROOM  
FLEX DINING / PROD. AREA  
WIRELESS INTERNET  
14' X 16' SKYLIGHT

**SIZE**  
35' X 39' X 13'  
1365 SF

**1 WALL CYC**  
26.5' X 22' X 13'



**SKY BOX CULVER CITY**  
IDEAL FOR BEAUTY PORTRAITS  
DAYLIGHT SHOTS + SMALL EVENTS,  
WORKS WELL IN TANDEM  
WITH BLACKBOX

## SMASHBOXSTUDIOS

SMASHBOXSTUDIOS.COM

CULVER CITY

(323) 851 5030

# SMASHBOX SKYBOX

8549 HIGUERA ST  
CULVER CITY, CA 90232  
323.851.5030 FAX 323.851.5029  
WWW.SMASHBOXSTUDIOS.COM

## STAGE FEATURES

WIRELESS INTERNET ACCESS  
CELEBRITY DRESSING ROOMS  
FULLY EQUIPPED PRODUCTION  
OFFICES, DELEGATED PARKING  
AND PRIVATE LOUNGE.  
ACCESS TO:  
COFFEE & TEA BAR, PING PONG  
TABLE AND LOUNGE AREA

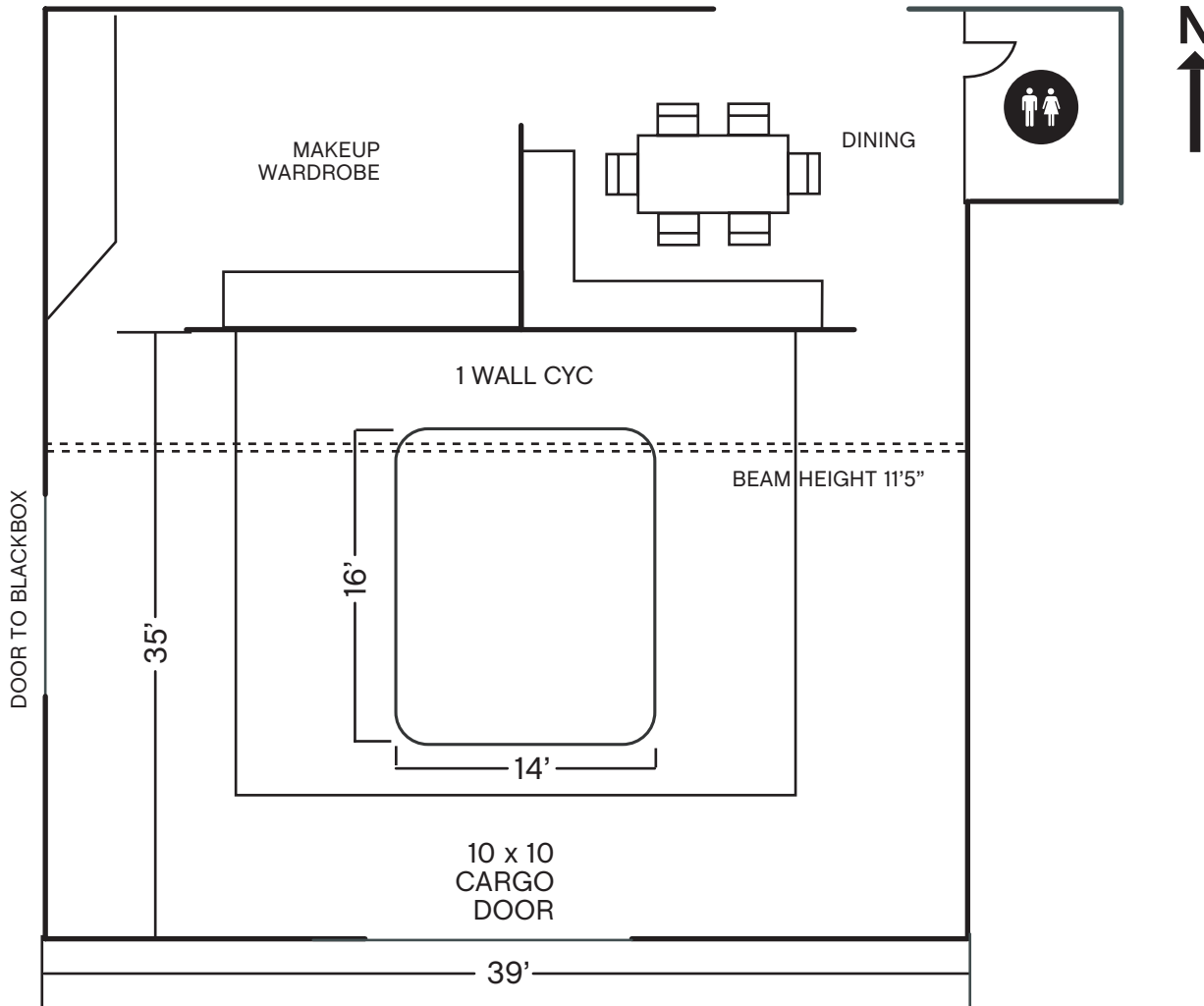

| STAGE   | DIMENSIONS   | SQ. FT | CYC                  | POWER            |
|---------|--------------|--------|----------------------|------------------|
| SKY BOX | 35 x 39 x 13 | 1365   | 1 WALL: 25 x 22 x 13 | 100 x 2, 3 PHASE |

# SMASHBOX

8549 HIGUERA ST  
 CULVER CITY, CA 90232  
 323.851.5030 FAX 323.851.5029  
 WWW.SMASHBOXSTUDIOS.COM

## STAGE FEATURES

- WIRELESS INTERNET ACCESS
- CELEBRITY DRESSING ROOMS
- FULLY EQUIPPED PRODUCTION OFFICES, DELEGATED PARKING AND PRIVATE LOUNGE.
- ACCESS TO:  
 COFFEE & TEA BAR, PING PONG TABLE AND LOUNGE AREA

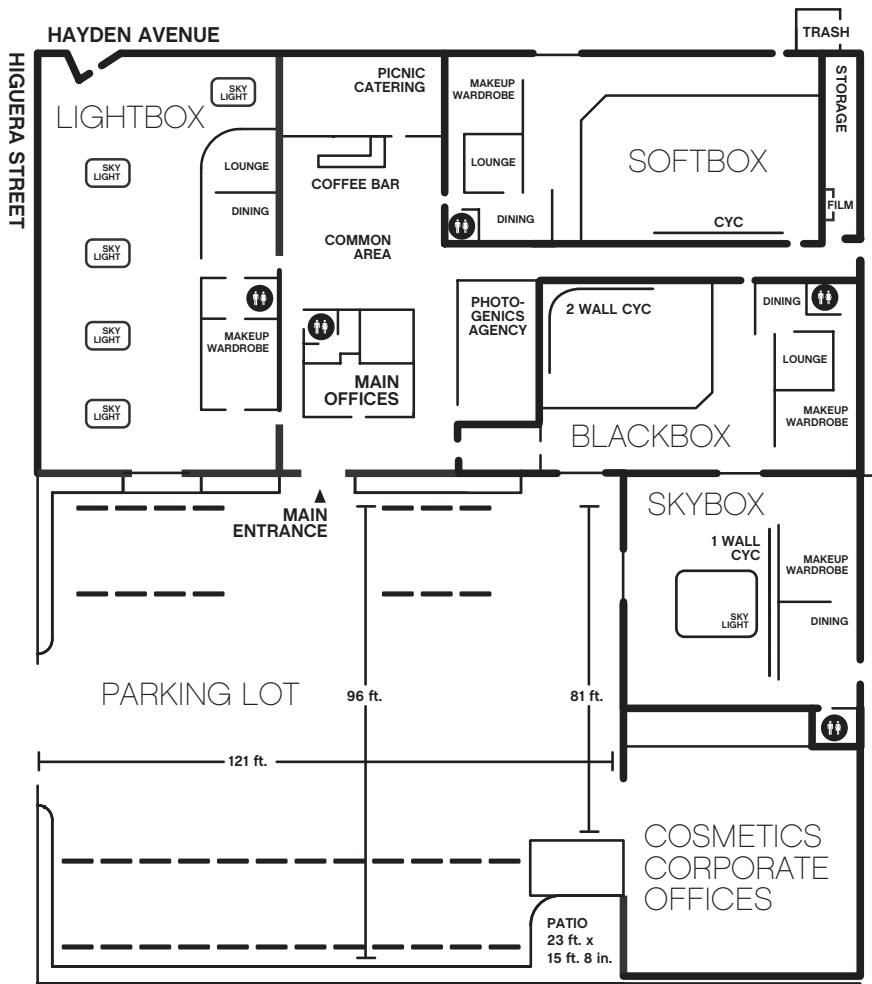

FENCE

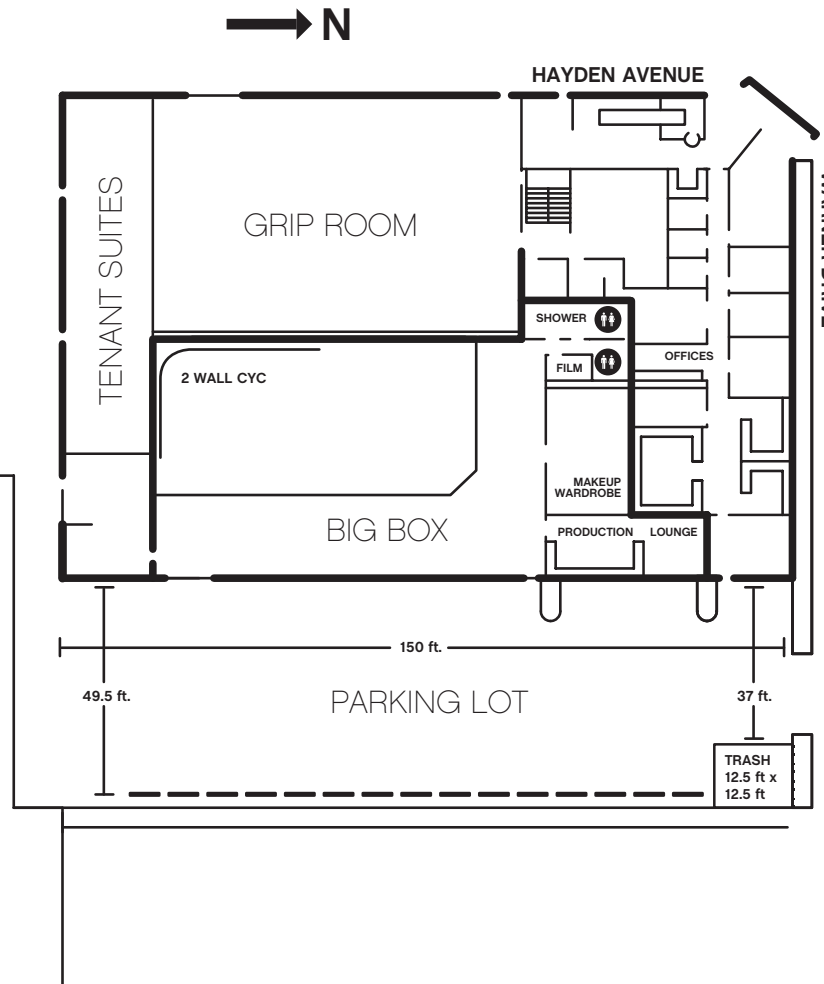

| STAGE     | DIMENSIONS                               | SQ. FT | CYC                  | POWER                     |
|-----------|--|--------|----------------------|---------------------------|
| BLACK BOX | 38 x 48 x 22                             | 1824   | 2 WALL: 31 x 35 x 22 | 200, 3 PHASE <sup>+</sup> |
| LIGHT BOX | 32 x 75 x 18**<br><small>beam=12</small> | 2400   | N/A                  | 200, 3 PHASE <sup>+</sup> |
| SKY BOX   | 35 x 39 x 13<br><small>beam=11.5</small> | 1365   | 1 WALL: 25 x 22 x 13 | 100 x 2, 3 PHASE          |
| SOFT BOX  | 35 x 55 x 22                             | 1925   | 1 WALL: 28 x 36      | 200, 3 PHASE <sup>+</sup> |
| BIG BOX   | 49.6 x 80 x 20                           | 3968   | 2 WALL: 32 x 64 x 20 | 600 x 2 PER DISTRO PANEL  |

\*\*10 x 10 NEAR SKYLIGHT IN BACK CORNER OF LIGHTBOX<sup>+</sup> 600 AMPS TOTAL SHARED BETWEEN STUDIOS